

ORIFICE - JEWEL

Materiale: Ruby

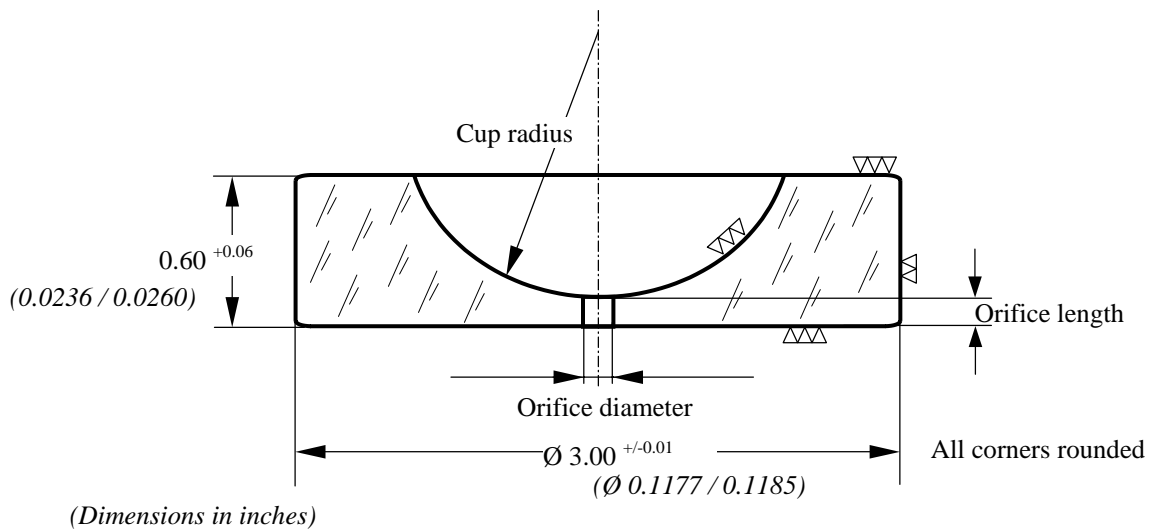

Dimensions in millimeter		
Orifice diameter	Orifice length*	SJC Part #
0.040 / 0.045	0.030 / 0.040	4698 / 1
0.050 / 0.054	0.040 / 0.050	4698 / 2
0.060 / 0.064	0.050 / 0.060	4698 / 3
0.068 / 0.072	0.055 / 0.065	4698 / 4
0.078 / 0.082	0.065 / 0.075	4698 / 5
0.098 / 0.102	0.075 / 0.085	4698 / 6
0.120 / 0.124	0.115 / 0.130	4698 / 7

Dimensions in inches		
Orifice diameter	Orifice length*	SJC Part #
.00157 / .00177	.00118 / .00157	4698 / 1
.00197 / .00213	.00157 / .00197	4698 / 2
.00236 / .00252	.00197 / .00236	4698 / 3
.00268 / .00284	.00217 / .00256	4698 / 4
.00307 / .00323	.00256 / .00295	4698 / 5
.00386 / .00402	.00295 / .00335	4698 / 6
.00472 / .00488	.00453 / .00512	4698 / 7

\*other dimensions on request.

Für diese Zeichnung behalten wir uns alle Rechte vor. We reserve all rights for this drawing. Dimensions in : mm

Disegnato data: 1/2003

Contr.:

**SWISS JEWEL CO SA**  
**TENERO**